

APPROVED: _____
 DATE: _____ TITLE: _____

Rev	AWO #	Description	Date	Appr
-		RELEASED	5/18/05	
A		REDRAWN	02/17/12	

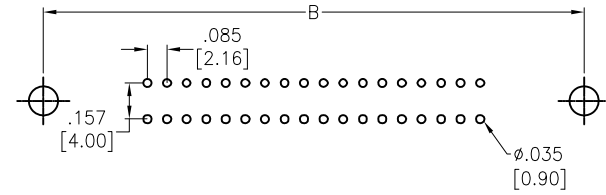

RECOMMENDED PCB LAYOUT

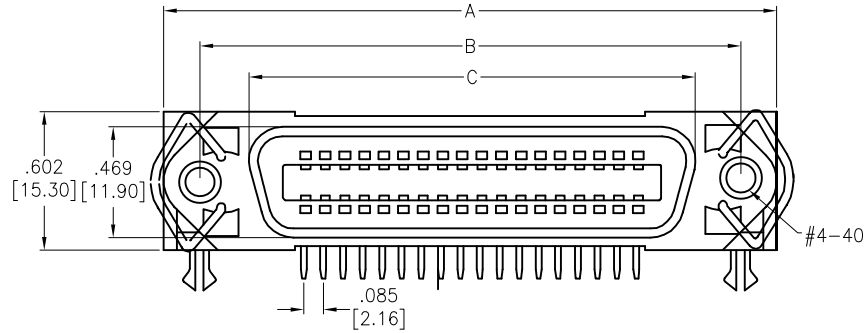
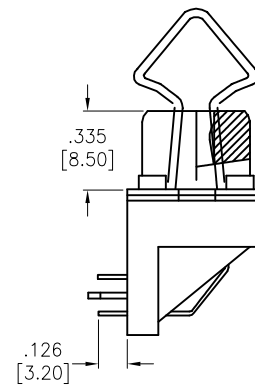
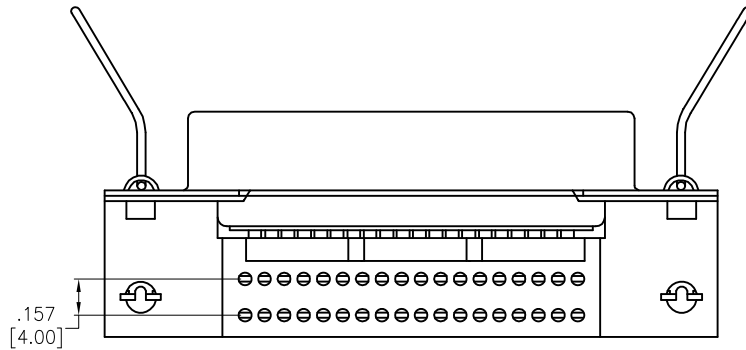

SPECIFICATIONS:

Material:
 Insulator: PBT, glass reinforced, rated UL 94V-0
 Insulator color: Blue
 Contacts: Copper Alloy
 Shell: Steel, Nickel plated
 Hood: Steel, Nickel plated

Plating:
 Gold flash over Nickel underplate on mating area,
 Tin over Nickel underplate on tails

Electrical:
 Current rating: 1 Amp
 Contact resistance: 25 mohms max
 Insulation resistance: 1,000 Mohms min @ 500V
 Dielectric withstanding voltage: 1,000 VAC for 1 minute
 Temperature Rating:
 Operating temperature: -55°C to +105°C

Environmental:
 Lead free, RoHS compliant



MRXX	NO. OF CONTACTS	DIMENSIONS		
		A	B	C
MR14	14	1.728 [43.90]	1.417 [36.00]	.992 [25.20]
MR24	24	2.154 [54.70]	1.843 [46.80]	1.417 [36.00]
MR36	36	2.665 [67.70]	2.350 [59.70]	1.925 [48.90]
MR50	50	3.260 [82.80]	2.949 [74.90]	2.524 [64.10]

UNLESS OTHERWISE SPECIFIED
 ALL DIMENSIONS ARE INCHES [MM]
 TOLERANCES: EXCEPT AS NOTED
 INCHES HOLES
 .X ± .10 Ø.X ± .10
 .XX ± .020 Ø.XX ± .015
 .XXX ± .015 Ø.XXX ± .010

ADAM TECH

909 Rahway Avenue, Union, NJ 07083
 Phone: 908-687-5000 Fax: 908-687-5710

TITLE: **MINIATURE RIBBON SOCKET, RIGHT ANGLE
 #4-40 INSERTS, FORKED BOARDLOCKS**

APPROVALS		DATE
DRAWN	SS	5/18/05
CHECKED		
APPROVED		

SIZE	PART NO.	REV.
X	MRXX-SD-14-F	A
REF:	S00033T	SCALE: NTS SHEET 1 OF 1