

APPROVED: \_\_\_\_\_  
 DATE: \_\_\_\_\_ TITLE: \_\_\_\_\_

Rev	AWO #	Description	Date	Appr
-		RELEASED	5/7/15	
A		UPDATED SPEC.	5/19/16	HR/RT

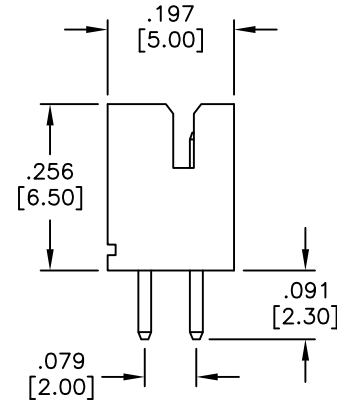
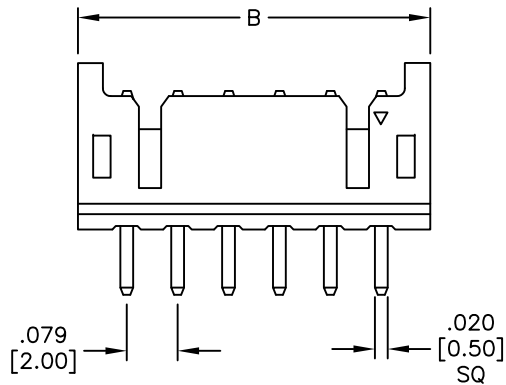
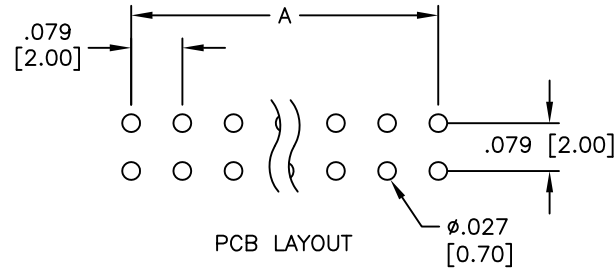
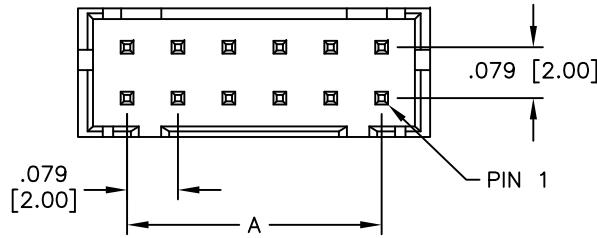

**SPECIFICATIONS:**

Material:  
 Insulator: Nylon 66, glass filled, rated UL 94V-0  
 Contacts: Brass  
 Plating:  
 Matte Tin over Nickel underplate overall  
 Electrical:  
 Operating voltage: 250 VAC max  
 Current rating: 3 Amps max  
 Contact resistance: 10 mohms max  
 Insulation resistance: 1,000 Mohms min @ 500 VDC  
 Dielectric withstanding voltage: 800 VAC for 1 minute  
 Temperature Rating:  
 Operating temperature: -25°C to +85°C  
 Environmental:  
 Lead free, RoHS compliant



Positions: 4 thru 34, 40  
 A = .079 [2.00] x No. of Spaces  
 B = .079 [2.00] x No. of Spaces +.154 [3.90]

UNLESS OTHERWISE SPECIFIED ALL DIMENSIONS ARE INCHES [MM] TOLERANCES: EXCEPT AS NOTED		<b>ADAM TECH</b> 909 Rahway Avenue, Union, NJ 07083 Phone: 908-687-5000 Fax: 908-687-5710	
INCHES HOLES			
.X ± .10	Ø.X ± .10	TITLE .079 [2.00] DOUBLE ROW, SHROUDED HEADER, STRAIGHT, PCB, MATTE TIN PLATED	
.XX ± .020	Ø.XX ± .015		
.XXX ± .015	Ø.XXX ± .010		
APPROVALS		DATE	
DRAWN	AY	5/7/15	
CHECKED	RT	5/7/15	
APPROVED			
SIZE	PART NO.	REV.	
X	2SHD-C-XX-MTS-.091	A	
REF:	S00123T	SCALE:	NTS
		SHEET 1 OF 1	