

APPROVED: _____
 DATE: _____ TITLE: _____

Rev	AWO #	Description	Date	Appr
-		RELEASED	10/13/14	
A		UPDATE DRAWING	11/1/19	LH/KL
B		UPDATE DRAWING	3/24/20	AY/TW

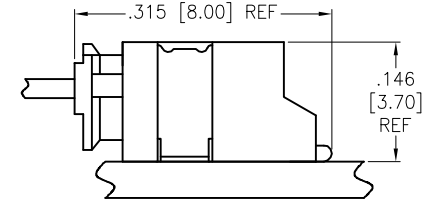
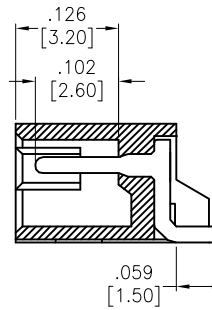
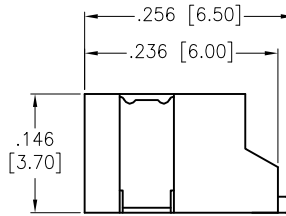
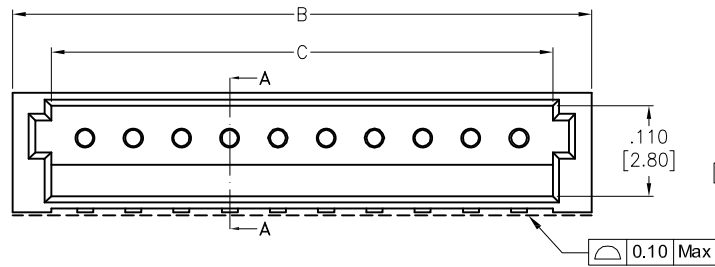
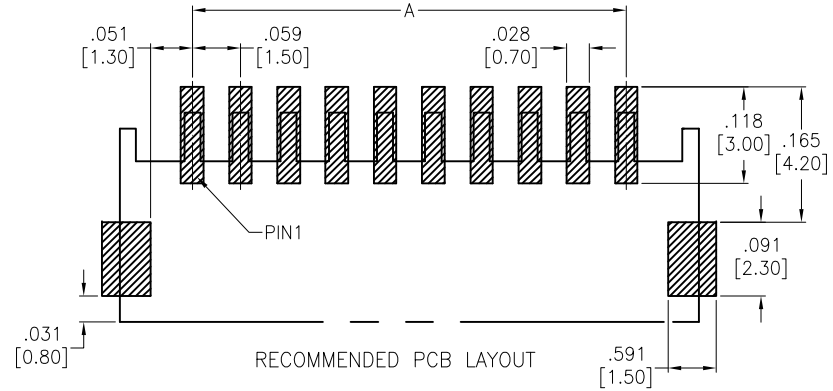
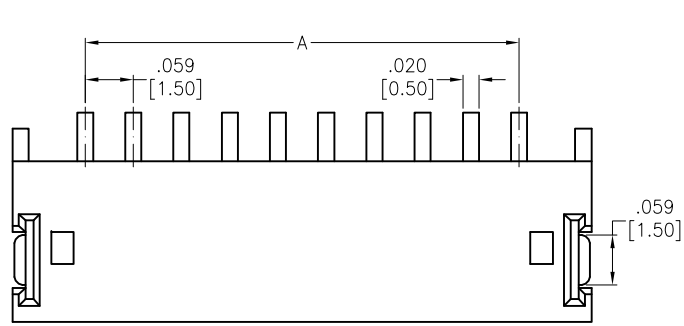

SECTION A-A

ASSEMBLY LAYOUT

SPECIFICATIONS:

Material:
 Insulator: Hi-Temp Thermoplastic, rated UL 94V-0
 Insulator color: Natural
 Contacts: Brass
 Plating:
 Matte Tin over Nickel underplate overall
 Electrical:
 Voltage rating: 50 V AC/DC
 Current rating: 1A AC/DC
 Contact resistance: 20 mohms Max
 Insulation resistance: 500 Mohms min
 Dielectric withstanding voltage: 500 VAC for 1 minute
 Temperature Rating:
 -25°C to +85°C
 Environmental:
 Lead free, RoHS compliant.



PACKAGED ON TAPE & REEL

Positions: 2 thru 15

A = .059 [1.50] x No. of Spaces

B = .059 [1.50] x No. of Spaces + .177 [4.50]

C = .059 [1.50] x No. of Spaces + .083 [2.10]

UNLESS OTHERWISE SPECIFIED
 ALL DIMENSIONS ARE INCHES [MM]
 TOLERANCES: EXCEPT AS NOTED

INCHES		HOLES	
.X	± .10	Ø.X	± .10
.XX	± .020	Ø.XX	± .015
.XXX	± .015	Ø.XXX	± .010

ADAM TECH
 INTERCONNECTS
 909 Rahway Avenue,
 Union, NJ 07083
 Phone: 908-687-5000
 Fax: 908-687-5710

APPROVALS		DATE	TITLE	
DRAWN	HR	10/13/14	MX1.5mm WAFER 90°, SMT, MATTE TIN PLATED	
CHECKED	RT	10/13/14	SIZE X	PART NO. 15SH-A-XX-MTR-SMT-T/R
APPROVED			REV. B	
REF: S00124T		SCALE: NTS	SHEET 1 OF 1	