

APPROVED: _____

DATE: _____ TITLE: _____

Rev	AWO #	Description	Date	Appr
-		RELEASED	1/22/24	

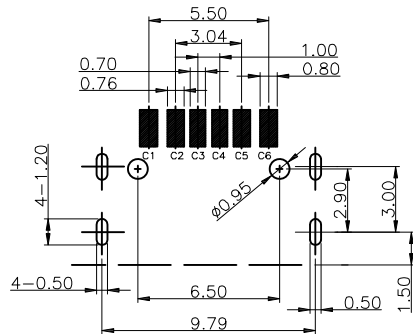

RECOMMENDED PCB LAYOUT

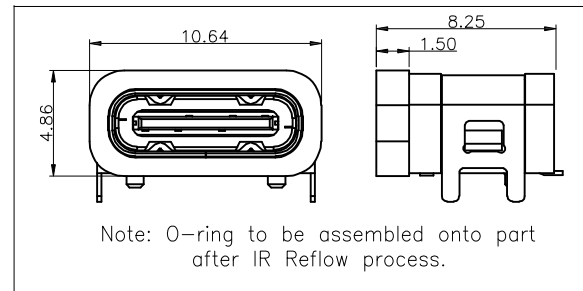
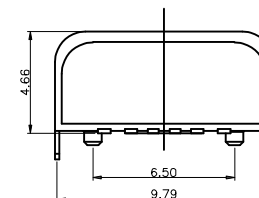
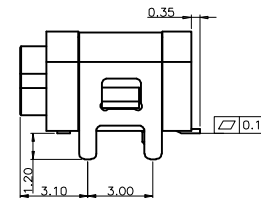
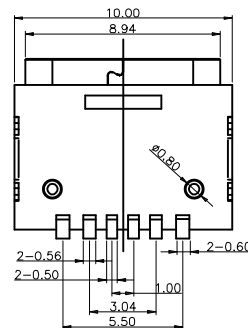
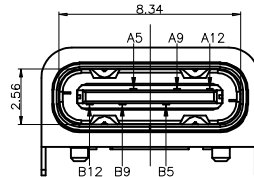
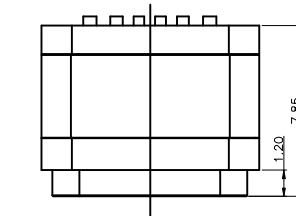

SPECIFICATIONS:

Material:

Insulator: Hi-Temp Thermoplastic, rated UL 94V-0

Insulator color: Black

Run-Ring: Silica gel, Color: Black

Contacts: Copper Alloy

Shield: Stainless Steel, Nickel Plated

Plating:

Gold flash over Nickel underplate overall

Electrical:

Voltage rating: 30 VAC

Current rating: 3.0A Max

Contact resistance: 40 mohms max

Insulation resistance: 100 Mohms min

Mechanical:

Insertion Force: 5N~20N

Removal Force: 8N~20N

Durability: 10,000 Cycles

Temperature Rating:

Operating temperature: -30°C to +85°C

Environmental:

Waterproof: IPX7

Lead free, RoHS compliant.



PIN ASSIGNMENT:

PIN NO	A1&B12	A4&B9	A5	B5	A9&B4	A12&B1
SIGNAL NAME	GND	VBUS	CC1	CC2	VBUS	GND
PCB PAD NO.	C1	C2	C3	C4	C5	C6

PACKAGED ON TAPE & REEL

TRANSMISSION EFFICIENCY: 480M

UNLESS OTHERWISE SPECIFIED ALL DIMENSIONS ARE MILLIMETERS. TOLERANCES: EXCEPT AS NOTED

MM	ANGLE
.X ± .35	X ± 3°
.XX ± .25	.X ± 1.5°

DRAWN	WX	1/22/24
CHECKED	RC	1/22/24
APPROVED		

THIS DRAWING CONTAINS INFORMATION THAT IS PROPRIETARY AND SHOULD NOT BE USED WITHOUT PRIOR WRITTEN PERMISSION FROM ADAM TECH

ADAM
TECH

909 Rahway Avenue,
Union, NJ 07083
Phone: 908-687-5000
Fax: 908-687-5710

TITLE UNIVERSAL SERIAL BUS TYPE C 2.0 6PIN, R/A
SMT, WATERPROOF IPX7, BLACK INSULATOR
POWER PIN ONLY TYPE

SIZE	PART NO.	REV.
X	USB-C20-S-RA-CS22E-SMT-WP-BK-T/R	-
REF:	S00192C	SHEET 1 OF 1