

6

5

4

3

2

1

APPROVED: \_\_\_\_\_

DATE: \_\_\_\_\_ TITLE: \_\_\_\_\_

Rev	AWO #	Description	Date	Appr
-		RELEASED	10/7/22	
A		UPDATE SPEC.	9/8/23	LH/RC

D

D

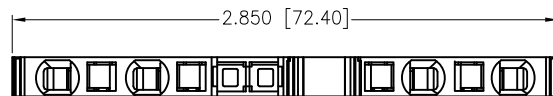

C

C

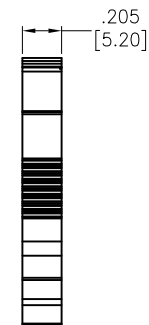
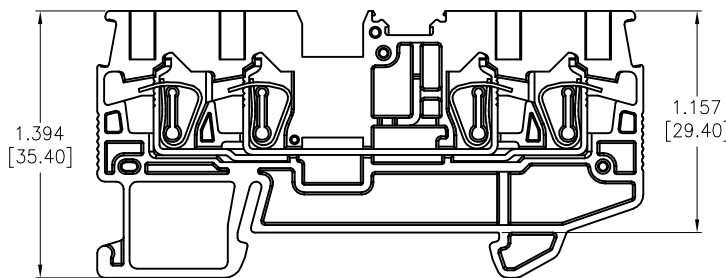
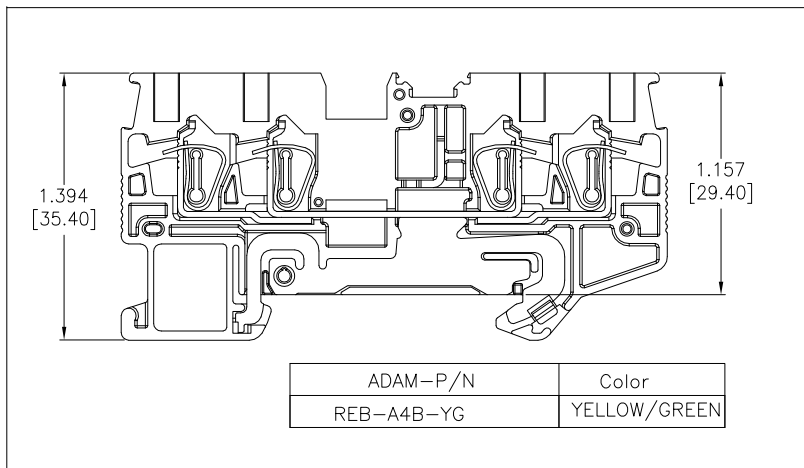

B

B

**SPECIFICATIONS:**

- Material: Insulator: PA66, rated UL 94V-0
- Insulator color: See chart
- Contacts: Copper Alloy, Tin Plated
- Electrical: Voltage rating: 600V
- Current rating: 20A
- Dielectric withstanding voltage: 2,200 VAC for 1 minute
- Mechanical:

**RECOMMENDED RAIL SIZE**  
35.0mm X 7.5mm

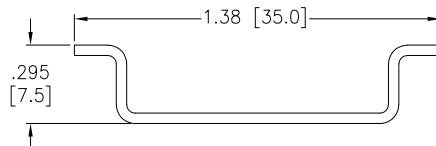

REB-A 4 B -XX	Color
	OR=Orange
	BU=Blue
	GY=Gray
	YG=Yellow/Green

ADAM-P/N	Color
REB-A4B-BU	BLUE
REB-A4B-GY	GRAY
REB-A4B-YG	YELLOW/GREEN

A

A

- Recommended Wire Size: Solid: 24-12AWG (0.2-3.3mm<sup>2</sup>)
- Stranded: 24-14AWG (0.2-2.1mm<sup>2</sup>)
- Stripping Length: .315"~.394" (8-10mm)
- Temperature Rating: Operating temperature: -40°C to +105°C
- Environmental: Lead free, RoHS compliant.



UNLESS OTHERWISE SPECIFIED ALL DIMENSIONS ARE INCHES [MM]. TOLERANCES: EXCEPT AS NOTED		
INCHES		
.x ± .10	∅x ± .10	
.xx ± .020	∅xx ± .015	
.xxx ± .015	∅xxx ± .010	

**ADAM TECH** 909 Rahway Avenue,  
Union, NJ 07083  
Phone: 908-687-5000  
Fax: 908-687-5710

DRAWN	WX	10/7/22
CHECKED	RC	10/7/22
APPROVED		

TITLE DIN RAIL TERMINAL BLOCKS, GUS, 4HOLE, 2.5 FLEXIBLE		
SIZE X	PART NO. REB-A4B-XX	REV. A

THIS DRAWING CONTAINS INFORMATION THAT IS PROPRIETARY AND SHOULD NOT BE USED WITHOUT PRIOR WRITTEN PERMISSION FROM ADAM TECH

REF: S00067C	SCALE: NTS	SHEET 1 OF 1
--------------	------------	--------------

6

5

4

3

2

1