

APPROVED: \_\_\_\_\_  
 DATE: \_\_\_\_\_ TITLE: \_\_\_\_\_

Rev	AWO #	Description	Date	Appr
-		RELEASED	11/21/05	
A		REVISED PIN DIM.	02/16/12	
B		UPDATE DRAWING	2/2/21	OW/RL

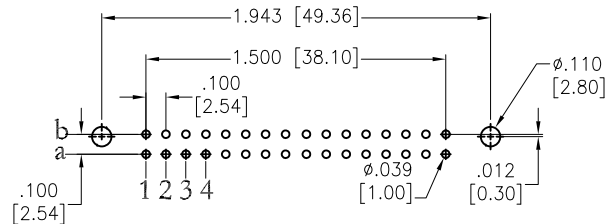
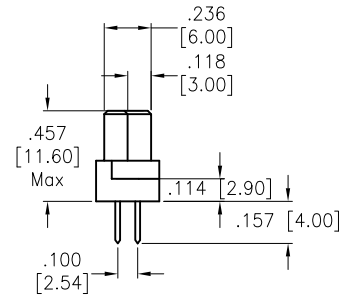
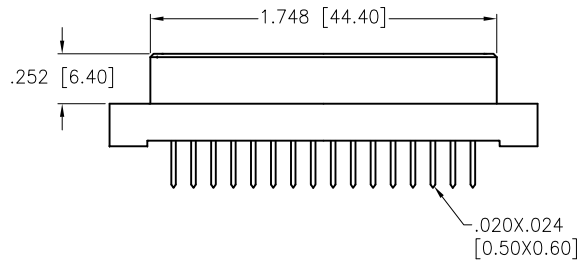
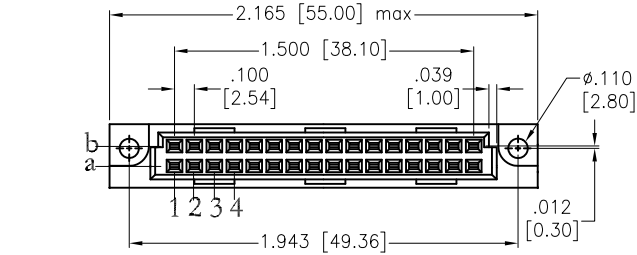

RECOMMENDED PCB LAYOUT

"X"	PLATING	CLASS
1	30 u" Gold	1
2	15 u" Gold	2
3	Gold Flash	3

**SPECIFICATIONS:**

Material:  
 Insulator: Thermoplastic Polyester Glass Filled, rated UL 94V-0  
 Contacts: Copper Alloy  
 Plating:  
 X Gold over Nickel underplate on contact area,  
 Tin over Copper underplate on solder tails.  
 (See chart for thickness)

Electrical:  
 Current rating: 2 Amp  
 Contact resistance: 20 mohms max  
 Insulation resistance: 1,000 Mohms min @ DC 500V  
 Dielectric withstanding voltage: 1000 VAC for 1 minute  
 Temperature Rating:  
 Operating temperature: -55°C to +125°C  
 Environmental:  
 Lead free, RoHS compliant



UNLESS OTHERWISE SPECIFIED  
 ALL DIMENSIONS ARE INCHES [MM]  
 TOLERANCES: EXCEPT AS NOTED  
 INCHES HOLES

.X ± .10	Ø.X ± .10
.XX ± .020	Ø.XX ± .015
.XXX ± .015	Ø.XXX ± .010



909 Rahway Avenue,  
 Union, NJ 07083  
 Phone: 908-687-5000  
 Fax: 908-687-5710

APPROVALS		DATE	TITLE	
DRAWN	SS	11/21/05	DIN TYPE HALF B, 32 PINS LOADED, 2 ROW STRAIGHT, ROWS A & B LOADED	
CHECKED			SIZE	PART NO.
APPROVED			X	DIN-32FS-S22-A1CX
REF: S00058T		SCALE: NTS	SHEET 1 OF 1	

REV. B