

| Rev | AWO # | Description | Date    | Appr |
|-----|-------|-------------|---------|------|
| -   |       | RELEASED    | 9/30/21 |      |

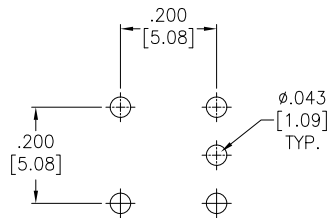

APPROVED: \_\_\_\_\_  
DATE: \_\_\_\_\_ TITLE: \_\_\_\_\_

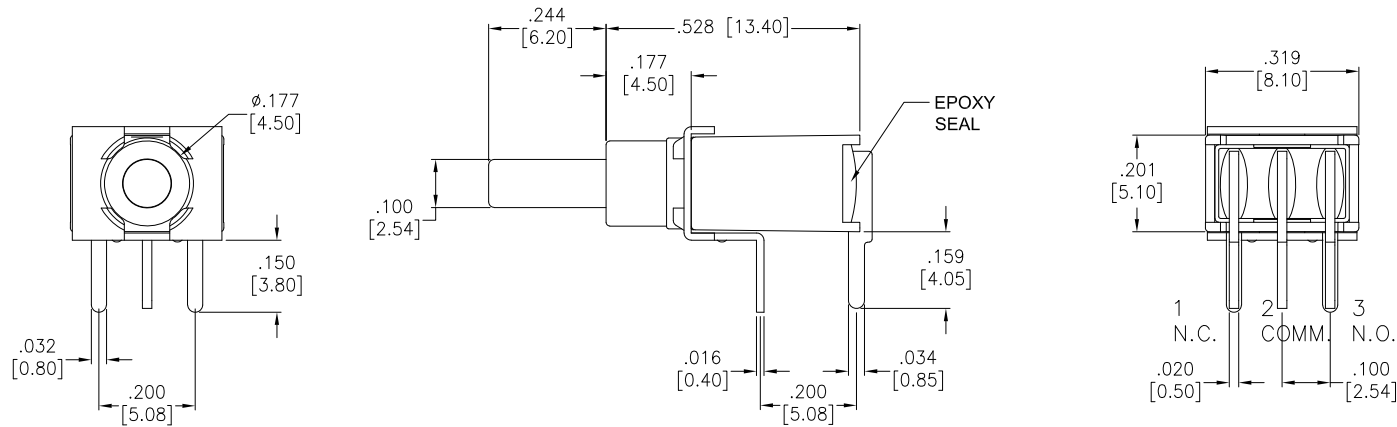
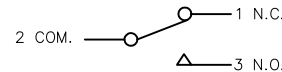

RECOMMENDED  
PCB LAYOUT

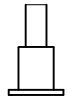

CIRCUIT DIAGRAM  
(SPDT)

| BUTTON POSITION |  |  |
|-----------------|--|--|
| FUNCTION        | ON   | MOM  |
| TERMINALS       | 2-1  | 2-3  |

SPECIFICATIONS:

Material:

Case: PA9T, Rated UL94V-0, color Red

Plunger: FR52, Rated UL94V-0

Bushing: PA9T, Rated UL94V-0

Movable Contact: Copper Alloy, Gold over Nickel under plate.

Terminal: Copper Alloy, Gold over Nickel under plate.

Electrical:

Rating: 0.4A max @ 20V AC or DC

Contact resistance: 20 mΩ max

Insulation resistance: 1,000 Mohms min

Dielectric withstanding voltage: 1,500V RMS @Sea level

Life: 30,000 cycles at full load

Temperature Rating:

Operating temperature: -30°C to +85°C

Environmental:

Sealed IP67 Rated

Lead free, RoHS compliant



| UNLESS OTHERWISE SPECIFIED ALL DIMENSIONS ARE INCHES [MM]. TOLERANCES: EXCEPT AS NOTED |       |       |       |
|--|-------|-------|-------|
| INCHES   |       | HOLES |       |
| .X   | ±.10  | Ø.X   | ±.10  |
| .XX  | ±.020 | Ø.XX  | ±.015 |
| .XXX   | ±.015 | Ø.XXX | ±.010 |

|          |    |         |
|----------|----|---------|
| DRAWN    | JJ | 9/30/21 |
| CHECKED  | RC | 9/30/21 |
| APPROVED |    |         |

THIS DRAWING CONTAINS INFORMATION THAT IS PROPRIETARY AND SHOULD NOT BE USED WITHOUT PRIOR WRITTEN PERMISSION FROM ADAM TECH



909 Rahway Avenue,  
Union, NJ 07083  
Phone: 908-687-5000  
Fax: 908-687-5710

| TITLE  |            |              | SIZE | PART NO.           | REV. |
|--|------------|--------------|------|--------------------|------|
| SEALED SUB-MINIATURE PUSH BUTTON SWITCH, SPDT, ON-MOM, GOLD PLATED, PCB TAILS, RIGHT ANGLE |            |              | X    | SW-PB9-AAB00A2RE-6 | -    |
| REF: S00198T   | SCALE: NTS | SHEET 1 OF 1 |      |                    |      |