

6

5

4

3

2

1

APPROVED: _____

DATE: _____ TITLE: _____

Rev	AWO #	Description	Date	Appr
-		RELEASED	1/23/18	

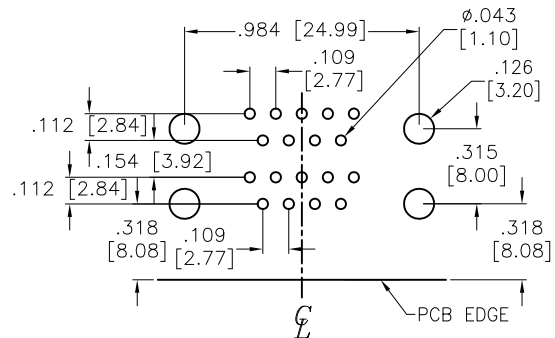
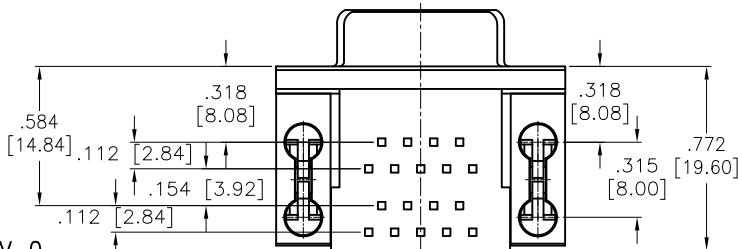
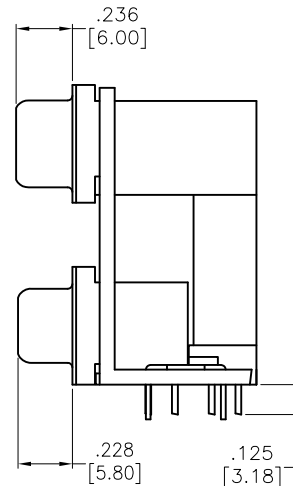
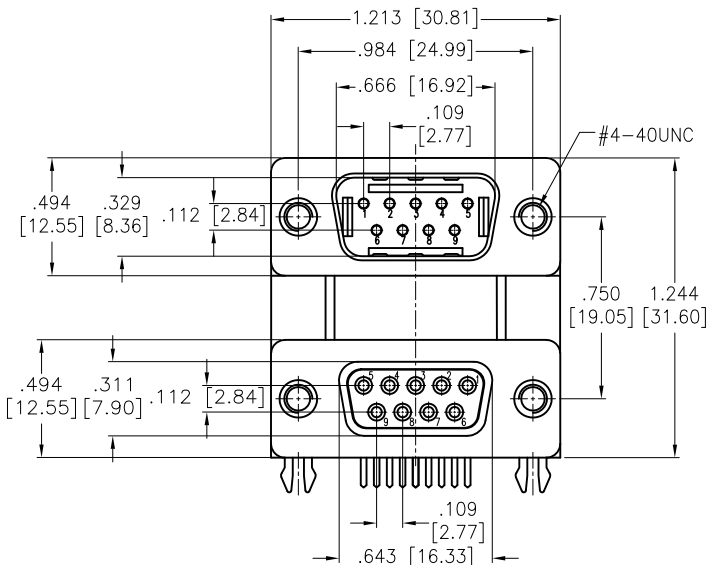

RECOMMENDED PCB LAYOUT

SPECIFICATIONS:

- Material:
- Insulator: PBT, rated UL 94V-0
- Insulator color: Black
- Contacts: Copper Alloy
- Shell: SPCC, Nickel plated
- Boardlock: Copper Alloy, Tin, plated
- Bracket: Zinc Alloy, Nickel plated
- Plating:

- Gold over Nickel underplate on contact area,
- Tin over Nickel underplate on solder tails

- Electrical:
- Voltage: 250 VAC max
- Current rating: 3 Amp per Contact
- Contact resistance: 25 mohms max
- Insulation resistance: 5,000 Mohms min
- Dielectric withstanding voltage: 1000 VAC for 1 minute
- Temperature Rating:
- Operating temperature: -55°C to +85°C

- Environmental:
- Lead free, RoHS compliant



UNLESS OTHERWISE SPECIFIED ALL DIMENSIONS ARE INCHES [MM] TOLERANCES: EXCEPT AS NOTED		
INCHES		HOLES
.X ± .10	Ø.X ± .10	
.XX ± .020	Ø.XX ± .015	
.XXX ± .015	Ø.XXX ± .010	
APPROVALS		DATE
DRAWN	AY	1/23/18
CHECKED	MY	1/23/18
APPROVED		

ADAM TECH INTERCONNECTS 909 Rahway Avenue,
Union, NJ 07083
Phone: 908-687-5000
Fax: 908-687-5710

TITLE DUAL PORT D-SUB, MALE / FEMALE 9 POSITION, FORKED BOARD LOCKS		
SIZE X	PART NO. DPD-09-10-B3	REV. -
REF: S00027T	SCALE: NTS	SHEET 1 OF 1

6

5

4

3

2

1